

MAP
F 14
1984/261
BENJAMIN PEARSE
7 KERSHAM AVE.
HAMPTON, NH.

MAP
F 37
211/456
EDDY WHITCOMB
MAIN STREET
BROOKLINE, NH.

MAP
F 16
1639/281
FRANK LAFALCI
RFD #1
BROOKLINE, NH.

OLD COUNTY ROAD

BROOKLINE

ROAD

4139A

MAP
F 15
6.110A

MAP
F 36
1801/488
CHAS BABE
BROOKLINE RD.
MASON, NH.

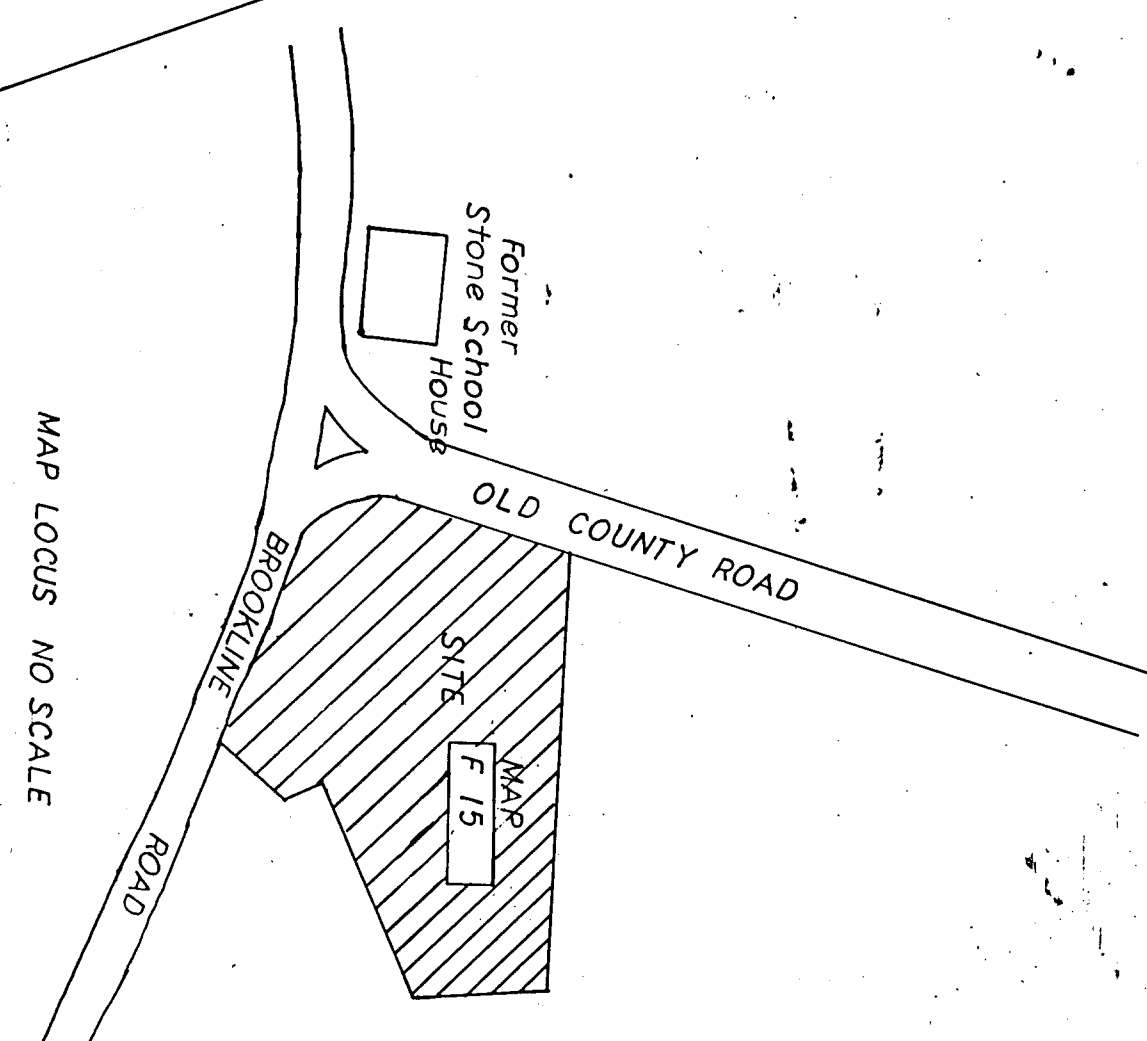

"The Subdivision Regulations of the Town of Mason are a part of this plat and approval of this plat is contingent on completion of all the requirements of said Subdivision Regulations, excepting only any variances or modifications made in writing by the Board and attached hereto."

R. Francis Ward RLS.
HOLLIS-NH.
APPROVED-MASON PLANNING BOARD
CHM. *R. Francis Ward*
Sec. _____
Date *MAR. 30, 1978*

SURVEYED FOR
THOMAS SHEUCHENKO
MASON-NH.
REF. _____ 2983/670
SCALE _____ 1"=50'
DEC. _____ 1977



R. Francis Ward RLS.